

CASS AVE.

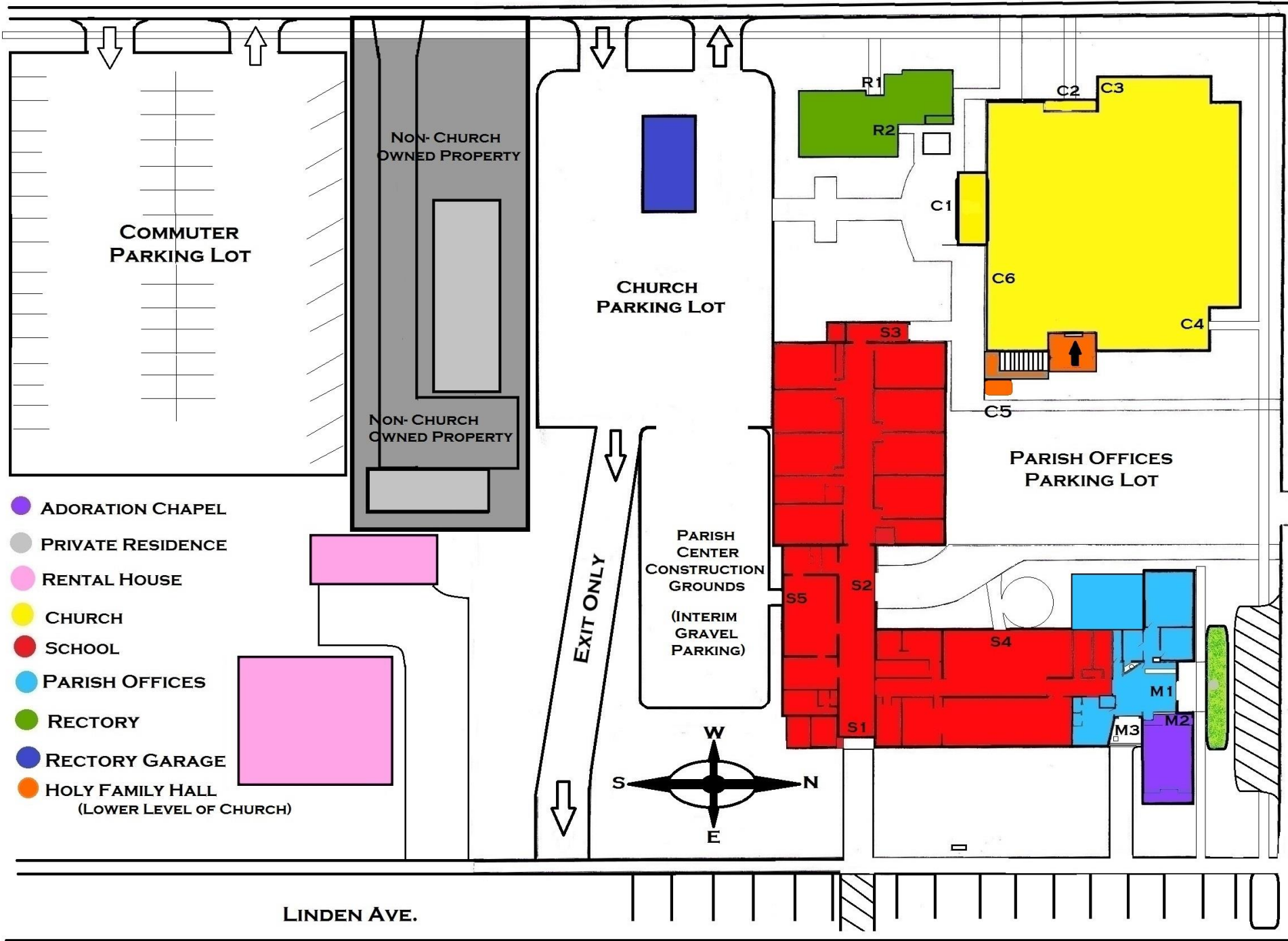

RICHMOND ST.

- ADORATION CHAPEL
- PRIVATE RESIDENCE
- RENTAL HOUSE
- CHURCH
- SCHOOL
- PARISH OFFICES
- RECTORY
- RECTORY GARAGE
- HOLY FAMILY HALL
(LOWER LEVEL OF CHURCH)

EXIT ONLY

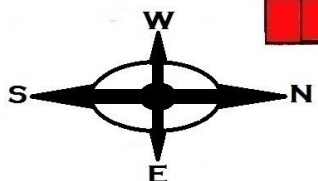

LINDEN AVE.